

SBB EC car evolutions

L.S. Models
Exclusive

Bt car

For this car you will have the choose between ten different construction versions

This car has a very detailed specific boogie, different than the A, B and Panorama car

Pre equipped with function decoder plug

Equiped with PCB for front light inversion, top light and cabin light

Prepared to received AC pick-up



2nd delivery (2004) two UIC plugs



1st delivery (1997) one UIC plug

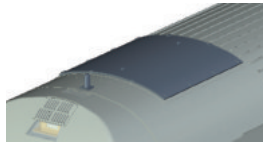

Original version with one antenna

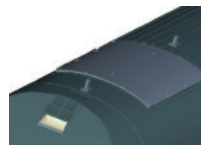

Refit version with two antennas



Actual version with three antennas

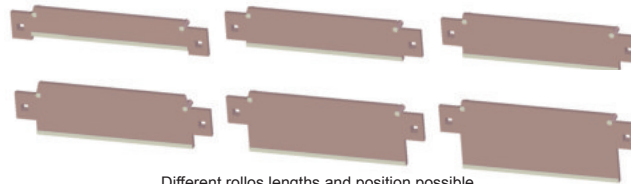

Different rollos lengths and position possible



Movable up/down step



Short buffer beam accessories for using additional front coupling (spare bag)



Additional front coupling (spare bag)
Driving version : add this coupling, remove cow catcher and bogie induci device



Electrical pick-up (spare bag)



Original destination table holder with car number plate/holder
or
without this holders and no car number plate/holder

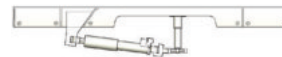

Skirt for running, fixed on bogie (delivery state, min. radius 360°)



Damper without skirt fixed on bogie (spare bag, min. radius 360°)

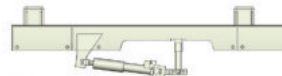

Skirt for showcase version fixed on body (spare bag)



Original destination box with car number plate/holder



Destination box closed by plate
No car number plate/holder



Electronic destination panel
No car number plate/holder



Long buffer beam accessories for showcase version (spare bag)



Folded table



Open table

Apm car

For this car you will have the choose between eight different construction versions

This car has a very detailed specific boogie

Electrical pick-up added in the spare bag

Prepared to received AC pick-up

Cars with a lot of different interior configurations, some versions are equipped with business compartment and/or bicycle rack



Without antenna



With antenna



Folded table

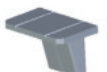

Open table

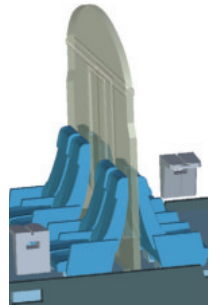

Compartment wall with door

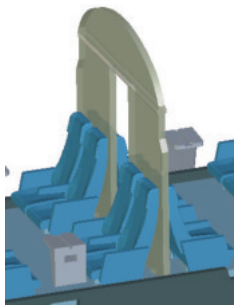

Compartment wall without door

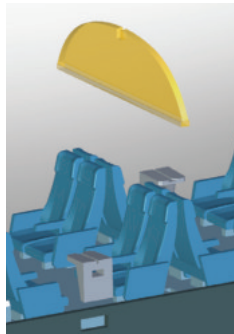

Only upper sail



Different rollo lengths and position possible



Versions with and without bicycle rack



Origin door opening or modernized one



Original destination table holder with car number plate/holder or without this holders and no car number plate/holder



Damper for running fixed on bogie (delivery state, min. radius 360°)



Damper for showcase version fixed on body (spare bag)



Versions with and without additional grid



Original destination box with car number plate/holder



Destination box closed by plate No car number plate/holder



Electronic destination panel No car number plate/holder



Long buffer beam accessories for showcase version (spare bag)

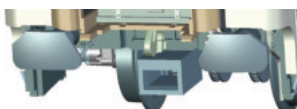

Origin buffers



Actual buffers



Electrical pick-up (spare bag)



With toilet tube or water tank



Origin door opening or modernized one

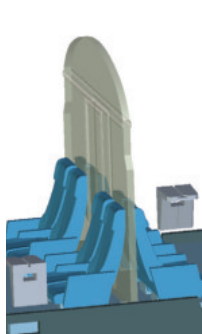

Compartment wall with door

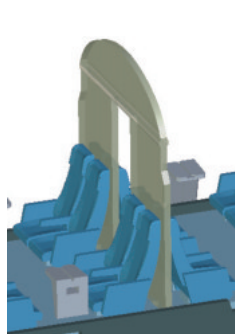

Compartment wall without door

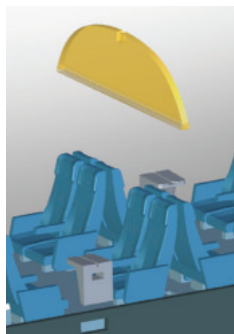

Only upper sail

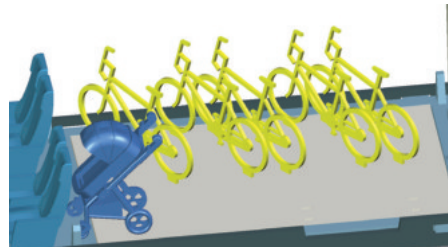

Bicycles compartment



Handicap compartment

Bpm car

For this car you will have the choose between eleven different construction versions

This car has a very detailed specific boogie

Electrical pick-up added in the spare bag

Prepared to received AC pick-up

Cars with a lot of different interior configurations, some versions are equipped with handicap chairs, some with bicycles/baby stroller compartment and/or bicycle rack



With toilet tube or water tank

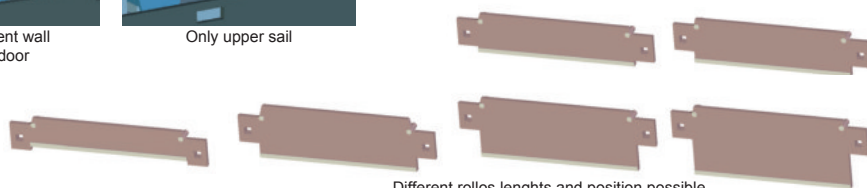

Different rollos lengths and position possible



Versions with and without bicycle rack

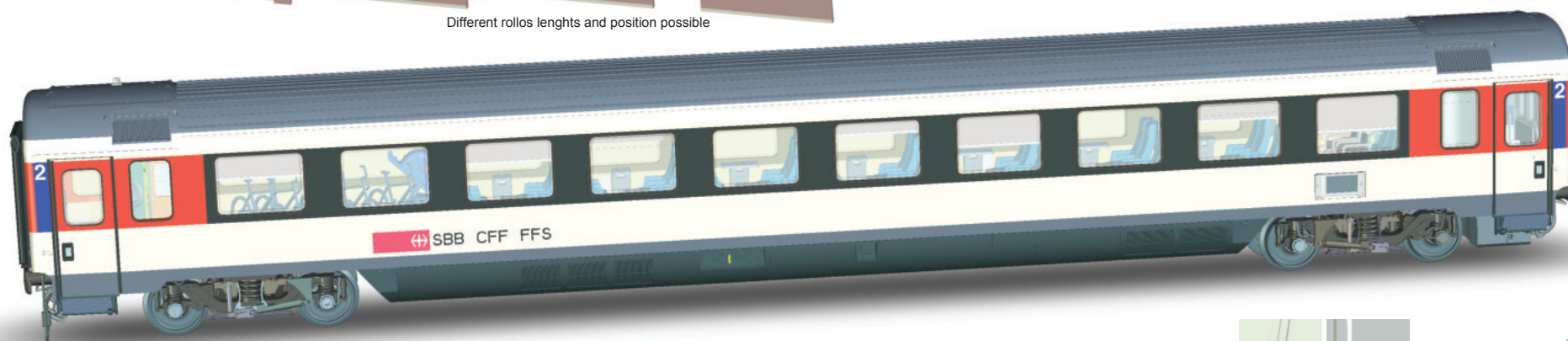

Original destination table holder with car number plate/holder or

without this holders and no car number plate/holder



Without antenna



With antenna



Versions with and without additional grid

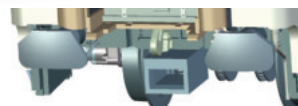

Origin buffers



Actual buffers



Origin door opening or modernized one



Long buffer beam accessories for showcase version (spare bag)



Origin door opening or modernized one



Normal toilet



Handicap toilet



Folded table



Open table



Damper for running fixed on bogie (delivery state, min. radius 360°)



Damper for showcase version fixed on body (spare bag)



Electrical pick-up (spare bag)



Some version will be equipped with bicycles, handicap chairs or baby stroller



Original destination box with car number plate/holder



Destination box closed by plate No car number plate/holder



Electronic destination panel No car number plate/holder

Apm Panorama car

For this car you will have the choose between three different construction versions

This car has a very detailed specific boogie

Electrical pick-up added in the spare bag

Prepared to receive AC pick-up

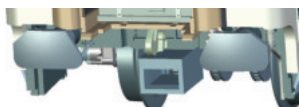

Origin buffers



Actual buffers

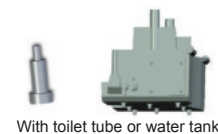

With toilet tube or water tank



Original destination box with car number plate/holder



Destination box closed by plate No car number plate/holder



Original destination table holder with car number plate/holder or without this holders and no car number plate/holder



Origin door opening or modernized one

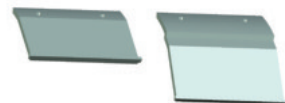

Different rollos lengths and position possible



Electrical pick-up (spare bag)



Long buffer beam accessories for showcase version (spare bag)

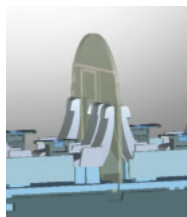

Separation wall with door or without door

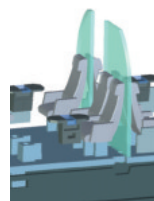

Damper for running fixed on bogie (delivery state, min. radius 360°)



Damper for showcase version fixed on body (spare bag)

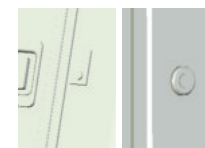

Origin door opening or modernized one